



# KAKADU



Sleeps 1-2



## Dimensions

6.5m Length  
2.4m Width  
3.0m Height



**Lock-Up**  
Starting price  
\$65,000



**Turn Key**  
Starting price  
\$95,000

The Kakadu has been designed with a simple open plan making it the ideal guest accommodation or airbnb rental. Spacious in size with a queen size mattress space sleeping up to two people.

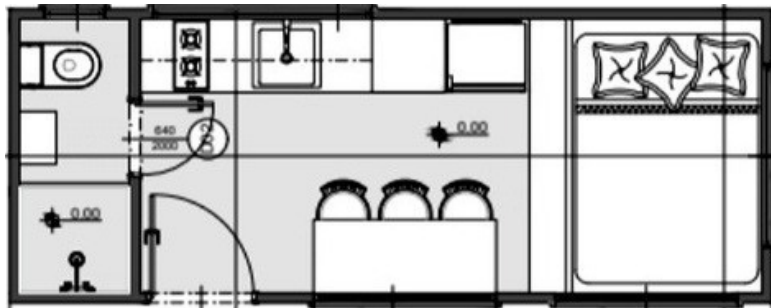

Ground Floor

# FEATURES



## Structure

- Tri-Axle 6.5m x 2.4m Trailer with Stabilisers and Electric Brakes
- Rated to 3.5 Ton
- Trucore Engineered Steel Frame
- Yellow Tongue Sheet Flooring
- Underfloor Insulation
- Earthwool R-2.5 Sound Shield Insulation

## Internal

- Easycraft Easy VJ Lining Boards to Walls & Ceiling
- Timber Laminate Flooring
- Fully Painted, Dulux White on White
- Built in Queen Size Bed Frame
- Breakfast Bar with Bi-Fold Window



## External

- Colorbond Steel Roof
- Colorbond Steel Wall Cladding
- Silvertop Ash Cladding to Front Facade
- Aluminum Low E Glass Doors & Windows
- Flyscreens to all Windows

## Kitchen

- Xenolith Kitchen Benchtop
- Polytec Soft Close Drawers & Cupboards
- Fisher & Paykel Two Burner Induction Cooktop
- ABI Interior Chrome Mixer Tap
- Single Stainless Sink with Drainer
- Bosch Electric Oven



## Bathroom

- 900mm x 1200mm Tiled Shower
- Wall Mount Vanity with Round Basin Bowl
- ABI Interiors Tapware
- Sliding Shower Screen with Aluminum Frame
- Back to Wall Toilet Suite
- Tiles to Floor of Bathroom
- Metal Frame Mirror



## Electrical

- Energy Efficient LED Downlights
- Exterior Up/Down Lights
- Double Power Points throughout
- Bathroom Exhaust Fan
- Smoke Detector
- 16Ltr Gas Hot Water System
- Safety Switchboard
- Power Inlet 15 AMP
- Mitsubishi 2.5kw Split System
- TV & Ariel Point
- Dual Gas Regulator