



KING ASH

The King Ash is a stunning single-storey design that boasts a well-appointed kitchen complete with built-in appliances, an integrated bar fridge, and a dedicated appliance cupboard. The layout includes a separate bedroom and a generously sized bathroom. Expansive windows invite in natural light and capture spectacular views. Perfectly suited as a guesthouse or Airbnb rental, it offers a luxurious short-stay accommodation experience.



Sleeps 1-4



Dimensions

9.5m Length
2.9m Width
4.3m Height



Lock-Up Stage

Starting price
\$87,460



Turn Key

Starting price
\$165,000

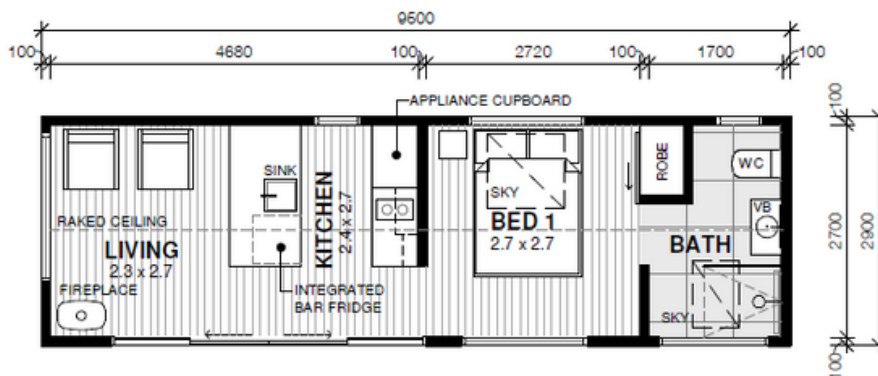

Ground Floor



Structure

- Tri-Axle 9.5m x 2.9m Trailer with Stabilisers and Electric Brakes
- Rated to 4.5 Ton
- Trucore Engineered Steel Frame
- Yellow Tongue Sheet Flooring
- Underfloor Insulation
- Earthwool R-2.5 Sound Shield Insulation

External

- Colorbond Steel Roof
- Colorbond Steel Wall Cladding
- Silvertop Ash Cladding to Front Facade
- Aluminium Low E-Glass Doors and Windows
- Flyscreens to all Windows
- Velux Skylights

Internal

- Easycraft Easy VJ Lining Boards to Walls & Ceiling
- Timber Laminate Flooring
- Fully Painted, Dulux White on White
- Charnwood Aire 3 Wood Heater
- Designer Kitchen with Island Bench
- Built in Wardrobe with Barn Style Door
- Roller Blinds to Windows
- Messmate Timber Bedside Table
- Charnwood Aire 3 Wood Heater

Kitchen

- Polytec Soft Close Drawers & Cupboards
- Xenolith Kitchen Benchtop
- Fisher & Paykel Induction Two Burner Cooktop
- ABI Interior Chrome Mixer Tap
- Single Stainless Sink with Drainer
- Bosch Electric Oven
- Appliance Cupboard
- Intergrated Bar Fridge
- Fisher & Paykel Draw Dishwasher

Bathroom

- 900mm x 1700mm Tiled Shower
- Messmate Timber Vanity with Round Basin Bowl
- ABI Interiors Fixtures, Tapware & Shower Head
- Frameless Fixed Shower Screen
- Back to Wall Toilet Suite
- Tiles to Floor of Bathroom
- Frameless Mirror

Electrical

- Energy Efficient LED Downlights
- Exterior Up/Down Lights
- Double Power Points throughout
- Bathroom Exhaust Fan
- Smoke Detector
- 16Ltr Gas Hot Water System
- Safety Switchboard
- Power Inlet 15 AMP
- Mitsubishi 2.5kw Split System
- TV & Ariel Point
- Dual Gas Regulator
- Ceiling Fan
- Internal Wall Feature Lights
- Strip Lights

