

# DUNDEE





# DUNDEE







# THE DUNDEE

Designed For Simplicity And Functionality

## Sleeps

x2 Queen Bed  
x1 Daybed

## Dimensions

8.4m length  
2.4m Width  
4.3m Height

## Price Guide

Starting price  
\$155,000

## Build Time

5 - 7  
Weeks

The Dundee doesn't just look stunning – it's highly practical too. Every square inch of the floor plan has been thought out thoroughly and built for functionality, and simplification.



Scan for a  
Virtual Tour!

## Ground Floor

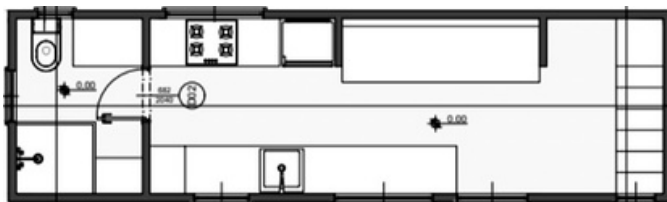

## Loft Floor

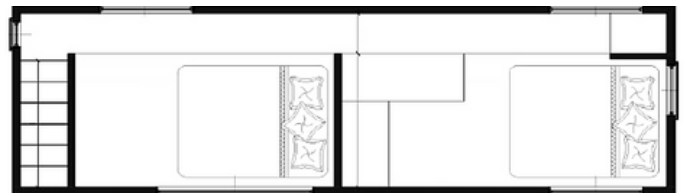



# FEATURES



## Structure

- Tri-Axle 8.4 x2.4m trailer with stabilisers & electric brakes rated to 4.5 ton
- Trucore engineered steel frame
- STRUCTAFLOOR yellow tongue + underfloor insulation
- Earthwool R-2.5 sound shield insulation

## External

- Colorbond steel roof cladding
- Colorbond steel wall cladding
- Aluminium low E-Glass doors and windows
- Cedar Shiplap feature wall cladding
- Flyscreens to all windows



## Internal

- Easycraft Easy VJ MDF lining to walls and ceiling
- Oak timber laminate flooring
- Fully painted, Dulux White on White

## Features

- Dual loft with wardrobe space
- Staircase storage to loft area
- Upholstered daybed with storage
- Space to mount TV in lounge area
- Study nook with American Oak benchtop



## Kitchen

- White kitchen cabinetry
- American Oak timber bench top
- Breakfast bar with bi-fold window
- Standard chrome tapware
- Two burner induction hot plate
- Bosch electric oven
- Fisher & Paykel draw dishwasher
- Soft close drawers and doors

## Bathroom

- Wall hung vanity
- European laundry
- Tiles to floor and wet areas
- Full size shower
- Back to wall toilet suite
- Standard chrome tapware



## Electrical

- External up-down lights
- Feature Wall light
- Mitsubishi 3.5kw split system
- 16ltr gas hot water system
- Smoke detector
- TV & Ariel point
- Dual gas regulator
- Power inlet 15AMP
- LED downlights
- LED strip lights
- USB power points
- Double power points
- Safety switchboard
- Water inlet





## CONTACT US

📞 0433 590 390

📍 515 Cooper Street, Campbellfield VIC

✉️ [admin@iconictinyhomes.com.au](mailto:admin@iconictinyhomes.com.au)

📘 Iconic Tiny Homes

📷 @iconictinyhomes

🌐 [iconictinyhomes.com.au](http://iconictinyhomes.com.au)



*View the Tiny  
Home Range!*



