



KAKADU 2.0



ICONICTINYHOMES.COM.AU



THE KAKADU 2.0

Designed For Simplicity And Functionality

Sleeps

x1 Queen Bed

Dimensions

6.2m Length
2.4m Width
3.0m Height

Price Guide

\$80,000.00

Build Time

4-6 weeks

The Kakadu 2.0 is the ultimate combination of simplicity and practicality. With reduced living costs and better sustainability, this cosy design requires fewer materials to construct, run and maintain, leading to some serious potential savings in the long and short term. Fully equipped with basic necessities required for you to enjoy whether it be used for permanent or short stay accommodation, this design can be customised to suit your needs.

Floorplan

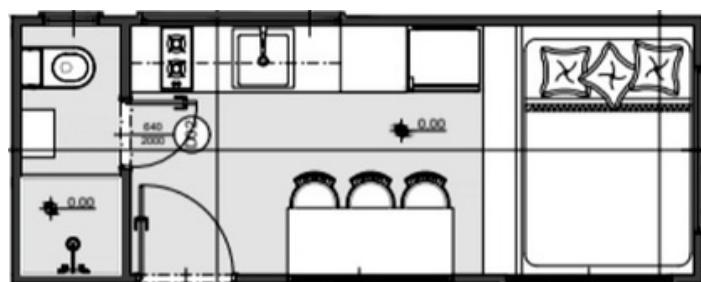



FEATURES

Structure

- Tri-Axle 6.2m x 2.4m trailer with stabilisers and electric brakes. Rated to 4.5 ton
- Trucore engineered steel frame
- Structaflor yellow tongue + underfloor insulation
- Earthwool R-2.5 sound shield insulation

Internal

- Fully painted, Dulux White on White
- Oak Timber laminate flooring
- Easycraft EasyVJ MDF lining to walls and ceiling

External

- Colorbond steel wall cladding
- Aluminum low E-Glass doors and windows
- Flyscreens to all windows
- Colorbond steel roof cladding

Features

- 1 x queen size ground level bedroom
- Airbnb style single level tiny home

Kitchen

- Two burner induction hot plate
- American Oak timber benchtop
- Soft close drawers and doors
- Breakfast bar with bi-fold window
- Standard chrome tapware
- Bosch electric oven
- White kitchen cabinetry

Bathroom

- Wall hung vanity
- Tiles to floor and wet areas
- Back to wall toilet suite
- Full size tiled shower
- Standard chrome tapware

Electrical

- TV & Ariel point
- Smoke detector
- Water Inlet
- Power inlet 15 AMP
- Safety switchboard
- Dual gas regulator
- Bathroom exhaust fan
- 16Ltr gas hot water system
- External up-down lights
- Double power points
- LED down lights
- USB power points
- 3.5kw Mitsubishi split system

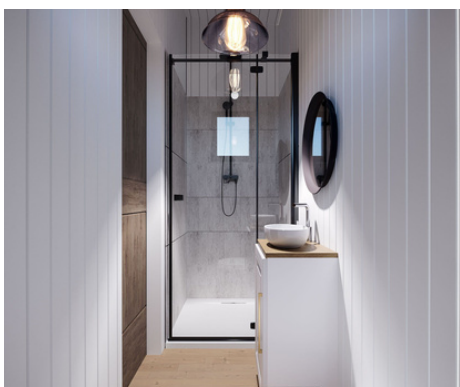



ICONIC
TINY HOMES

CONTACT US

📞 0433 590 390

📍 515 Cooper Street, Campbellfield VIC

✉️ admin@iconictinyhomes.com.au

📘 Iconic Tiny Homes

📷 @iconictinyhomes

🌐 iconictinyhomes.com.au



*View the Tiny
Home Range!*

