



THE DALY

The Daly is a spacious ground level tiny home designed with plenty of room to move. A simple open plan featuring a spacious kitchen and living area. Queen size bedroom with built in robes and a generous size bathroom including washing machine space. Perfect as an alternative to a traditional granny flat.



Sleeps 1-4

x1 Queen Bed
x1 Sofa Bed
(Optional)



Dimensions

9.0m Length
2.4m Length
3.0m Height



Price Guide

Starting price
\$125,000



Delivery

POA

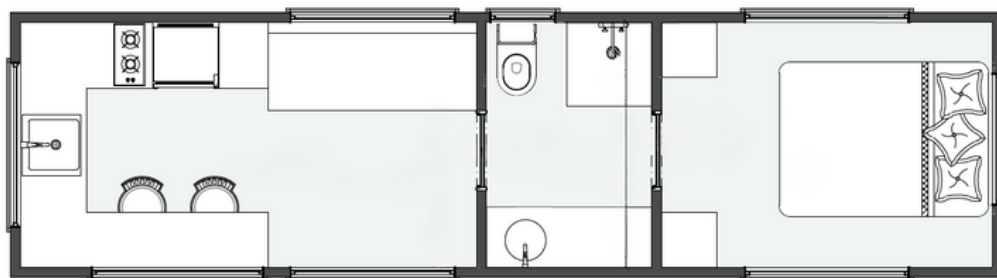

Ground Floor



FEATURES



Structure

- Tri-Axle 9.0m x 2.4m trailer with stabilisers and electric brakes.
- Rated to 4.5 TON
- Trucore engineered Steel Frame
- Structaflor yellow tongue + underfloor insulation
- Earthwool R-2.5 sound shield insulation

External

- Colorbond steel sureclad wall cladding
- Aluminum low E-Glass doors and windows
- Flyscreens to all windows
- Colorbond steel sureclad roof cladding
- Cedar shiplap feature wall cladding



Internal

- Easycraft lining boards to walls and ceiling
- Fully painted. Dulux White on White
- Hybrid timber laminate flooring

Features

- Spacious kitchen with breakfast bar
- Single level tiny home
- Built in bedroom wardrobes



Kitchen

- Breakfast bar with bifold window
- Fisher & Paykel two burner cooktop
- American oak timber benchtop
- White kitchen cabinetry
- ABI chrome tapware
- Soft close drawers and doors
- Fisher and Paykel dishwasher
- Bosch electric built-in oven
- Slide out rangehood

Bathroom

- Hybrid timber laminate flooring
- 900mm x 900mm tiled shower
- Built in vanity with washing machine space
- ABI chrome tapware
- Back to wall toilet suite



Electrical

- 3.5kw Mitsubishi split system
- Bathroom exhaust fan
- External up-down lights
- Double power points
- LED downlights
- TV & Ariel point
- Smoke detector
- 16Ltr Gas hot water system
- Internal feature light
- Power Inlet 15 AMP
- Safety Switchboard
- Dual gas regulator
- Water Inlet