



THE KAKADU

The Kakadu is a great choice for a guest house or airbnb rental. The ground level featuring a generous size bathroom, kitchen and living area including a built in daybed.



Sleeps 1-3

x1 Queen Bed
x1 Daybed



Dimensions

6.5m Length
2.4m Length
3.0m Height



Price Guide

Starting price
\$105,000



Delivery

POA

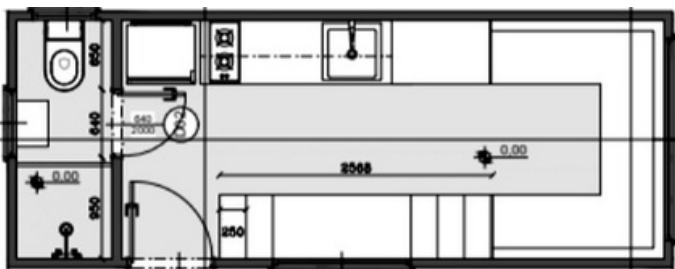

Ground Floor

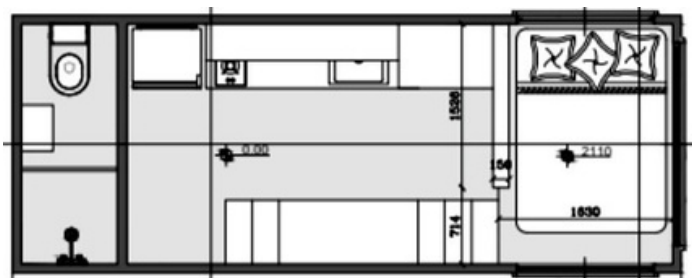

Loft Floor



FEATURES



Structure

- Tri-Axle 6.5m X 2.4m trailer with stabilisers and electric brakes rated to 3.5 ton
- Trucore engineered steel frame
- STRUCTAFLOOR yellow tongue + underfloor insulation
- Earthwool R-2.5 sound shield Insulation

Internal

- Easycraft lining boards to walls and ceiling
- Hybrid timber laminate flooring
- Fully painted, Dulux White on White



External

- Colorbond steel sureclad wall cladding
- Colorbond steel sureclad roof cladding
- Aluminium low E-Glass doors and windows
- Flyscreens to all windows

Features

- Bedroom loft with queen size mattress space
- Breakfast bar with bi-fold window
- Staircase storage
- Large upholstered daybed



Kitchen

- American Oak timber bench top
- Standard chrome tapware
- Fisher & Paykel two burner cooktop
- White kitchen cabinetry
- Bosch electric built-in oven
- Slide out rangehood
- Soft close drawers and doors
- ABI chrome tapware

Bathroom

- 900mm x 900mm tiled shower
- Floor mount vanity
- ABI chrome tapware
- Hybrid laminate timber flooring
- Back to wall toilet suite



Electrical

- Bathroom exhaust fan
- External up-down lights
- Double power points
- LED down lights
- Dual gas regulator
- Water inlet
- Mitsubishi 3.5kw split system
- TV & Ariel point
- Smoke detector
- 16ltr gas hot water system
- Safety switchboard
- Power inlet 15 AMP